



# 9100

**WITTENBERG**

designed to last



## USER-FRIENDLY TOUCH SCREEN

Just put your finger to the 10" HD touch screen and be guided through the many delicious drink choices.

## COFFEE EXACTLY TO YOUR TASTE

Espresso, American black coffee, blended drinks, layered drinks - made Your Way, simply by the touch of your finger.

## FLEXIBLE CANISTER

The flexible canister may offer two blends of coffee beans at the same time to suit different preferences. Each canister contains up to 4.3 lbs of coffee.

## ELEGANT DESIGN

LED lights frame the Scandinavian elegance of the aluminum facia and help ensure that the machine is both user-friendly and energy efficient.

## ADDED FEATURES FOR YOUR CONVENIENCE

The 9100 is a machine for the future and has been designed with a number of features like RSS feed\*, and online connectivity.

## PAYMENT SYSTEMS

Payment system or freevend, that is your choice. The machine supports coin or cashless systems at the same time.

## EASY MAINTENANCE

The smart design of the machine, the colour-coding of internal parts, and the intuitive interface reduces maintenance time, optimizes operational costs and improves customer satisfaction.

\*(a regularly updated summary of Web contents)

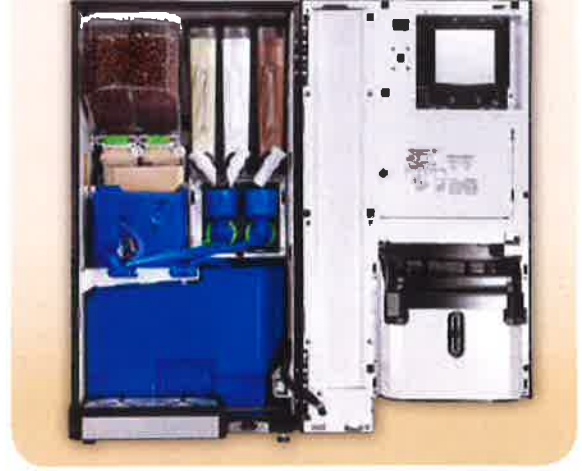

## ACCESSORIES

- Base stand
- Mechanical counter
- LED light kit
- Service light
- Powder sensors for coffee and instant canisters
- 4th soluble canister
- Grounds kit for base stand



Weight	165 lbs
Voltage	2300 watt
Coffee canister capacity	4.3 lbs
Soluble canisters capacity	5 lbs

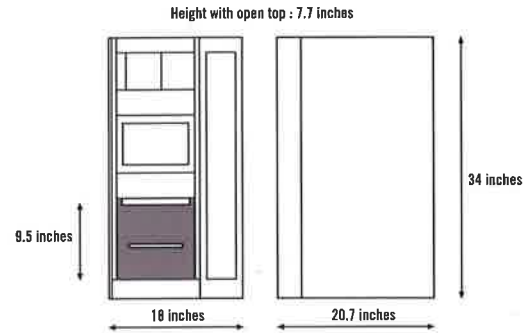

The 10" touch screen - 1280 x 800 - offers a visual guide, making choices easy. The design and layout of the screen can also be fully customized to suit any environment.



The user-friendly interface lets you prepare a drink just the way you like, allowing you to make changes to the strength and amount of ingredients. Up to 16 ounce / drinks. Up to 16 grams per drink plus 2 brew cycle options. You can even save your personalized drink in the layout with the quick two buttons modality or make drinks "Your Way".



The spacious delivery area with adjustable cup holders allows you to fill travel mugs and carafes.



Distributed by:

GLOBAL SOLUTIONS

VE GLOBAL SOLUTIONS, LLC

8700 Brookpark Road S Cleveland OH 44129 USA - P: 800.321.2511

Contact information:

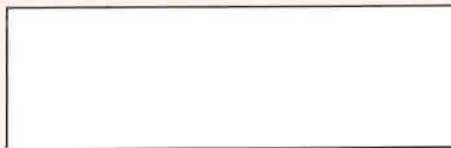

WITTENBORG IS A BRAND OF



N&W GLOBAL VENDING S.p.A.

Via Roma 24 - 24030 Valbrembo (BG) Italy